

Scale of equal parts 40 p^s to the inch

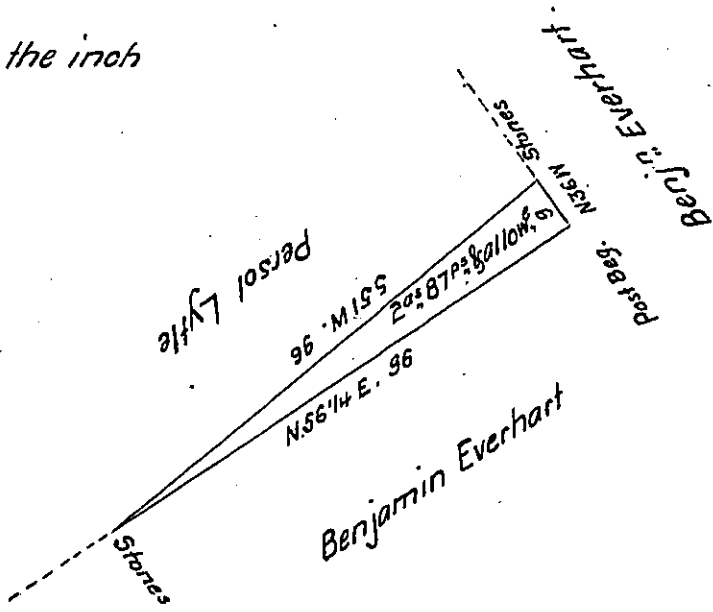

Draft of a tract of Land situate in Harris township Centre County containing two acres and eighty seven perches and allowance of six per cent for roads &c^o Surveyed the 20th day of April A.D. 1848 in pursuance of a Warrant granted to Benjamin Everhart dated 16th March 1848 for 3 acres

To John Laporte Esq^r }
 Surveyor General }

per Jacob Bollinger D.S.

IN TESTIMONY that the above is a copy of the original remaining on file in the Department of Internal Affairs of Pennsylvania, made conformably to an Act of Assembly approved the 16th day of February 1833, I have hereunto set my hand and caused the Seal of said Department to be affixed at Harrisburg, this twelfth day of October 1907

Henry Houck
 Secretary of Internal Affairs.